



# C&D TRUE FRONT ACCESS®

## TEL Series Float Service



TEL12-210F

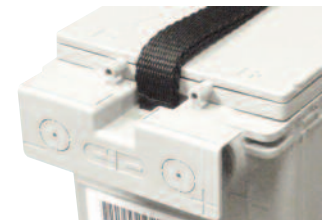

TEL12-210FG  
with TFA gas collection system



Typical Wireline Application



Typical Wireless Application

### **BENEFITS:**

- Long Life Float Service Design
  - Confirmed via 3rd party Certification
  - Premium alloy and material components
- True Front Access Design
  - True direct connect terminal for reliability
  - C&D Ohmic Ring® for accurate testing
  - Optional True Front Access gas collection system (models contain "G" suffix)
  - Connection versatility
- Maximum Performance
  - Superior output due to direct terminal connection
  - Low internal resistance
- Compliant to major global specifications
  - British Standard BS 6290: Part 4: 1997
  - IEC 60896-21/22
  - Telcordia SR-4228
  - Eurobat Guide Classification: Long Life
  - Bellcore GR-63-CORE & GR-1089-CORE
  - UL94 V-0FR
  - Non-Hazardous, not restricted for any transportation mode (air, water or land)

### **SPECIFICATIONS**

Battery	Voltage Per Unit	Ampere Hour Capacity 8 Hour Rate @ 77°F (25°C) to 1.75 v/c	Ampere Hour Capacity 10 Hour Rate @ 68°F (20°C) to 1.80 v/c	Maximum Discharge Current	Short Circuit Current	Ohms Impedance 60 Hz (Ω)	Battery Weight
TEL12-210F/FG	12 V	202 Ah	199 Ah	800 Amperes	4500 Amperes	0.0040 Ohms	132 lbs/60 kg

## SPECIFICATIONS

Ampere Hour Capacity to 1.75 Volts per Cell @77°F (25°C)  
Discharge in Hours

Model	1	2	3	4	5	6	7	8	10	12	20	24
TEL12-210F/FG	138	165	170	176	190	194	199	202	209	214	230	235

Ampere Hour Capacity to 1.80 Volts per Cell @68°F (20°C)  
Discharge in Hours

Model	1	2	3	4	5	6	7	8	10	12	20	24
TEL12-210F/FG	126	153	153	158	175	179	183	186	192	198	212	218

## DIMENSIONS

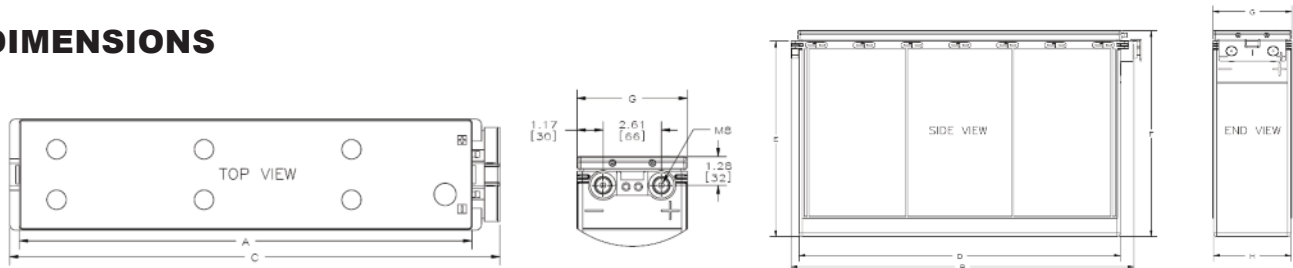

MODEL	A		B		C		D		E		F		G		H	
	in	mm	in	mm	in	mm	in	mm	in	mm	in	mm	in	mm	in	mm
TEL12-210F	20.3	516	21.5	546	22.0	559	20.1	512	12.2	310	12.6	320	4.9	126	4.8	123
TEL12-210FG	20.3	516	21.5	546	22.0	559	20.1	512	12.2	310	12.8	326	4.9	126	4.8	123

\* All dimensions in inches and (millimeters). All dimensions are for reference only. Contact a C&D Representative for complete dimensional information.

<b>Operating Temperature Range with temperature compensation</b>	Discharge: -40°F (-40°C) to 160°F (71°C) Charge: -10°F (-23°C) to 140°F (60°C)						
<b>Nominal Operating Temperature Range</b>	+68°F (20°C) to +80°F (27°C)						
<b>Recommended Maximum Charging Current Limit</b>	C <sub>20</sub> /5 Amperes (46 A)						
<b>Float Charging Voltage</b>	13.5 to 13.8 VDC average per 12V unit						
<b>Maximum AC Ripple (Charger)</b>	0.5% RMS or 1.5% P-P of float charge voltage recommended for best results. Max AC ripple voltage allowed = 1.4% RMS (4% P-P) Max AC ripple current allowed = 11.5 amperes RMS (C <sub>20</sub> /20)						
<b>Self Discharge</b>	Battery can be stored up to 6 months at 77°F (25°C) before a freshening charge is required. Batteries stored at temperatures greater than 77°F (25°C) will require recharge sooner than batteries stored at lower temperatures. See C&D bulletin 41-7272, Self-Discharge and Inventory Control for details.						
<b>Equalize charge and cycle service voltage</b>	14.40 to 14.80 VDC average per 12V unit @ 77°F (25°C)						
<b>Terminal: Inserted - Inter-unit connector and hardware provided</b>	Threaded copper alloy insert terminal to accept M8 bolt						
<b>Terminal Hardware Torque:</b>	160 in.-lbs. (18 N-m)						
<b>Telcordia Part Numbers</b>	<table border="0"> <tr> <td><b>Battery Part Number</b></td> <td><b>CLEI Code</b></td> <td><b>CPR</b></td> </tr> <tr> <td>TEL12-210F/FG</td> <td>Pending</td> <td>Pending</td> </tr> </table>	<b>Battery Part Number</b>	<b>CLEI Code</b>	<b>CPR</b>	TEL12-210F/FG	Pending	Pending
<b>Battery Part Number</b>	<b>CLEI Code</b>	<b>CPR</b>					
TEL12-210F/FG	Pending	Pending					

## C&D TECHNOLOGIES, INC.

1400 Union Meeting Road  
P.O. Box 3053 • Blue Bell, PA19422-0858  
(215) 619-2700 • Fax (215) 619-7899 • (800) 543-8630  
customersvc@cdtechno.com  
www.cdtechno.com

Any data, descriptions or specifications presented herein are subject to revision by C&D Technologies, Inc. without notice. While such information is believed to be accurate as indicated herein, C&D Technologies, Inc. makes no warranty and hereby disclaims all warranties, express or implied, with regard to the accuracy or completeness of such information. Further, because the product(s) featured herein may be used under conditions beyond its control, C&D Technologies, Inc. hereby disclaims all warranties, either express or implied, concerning the fitness or suitability of such product(s) for any particular use or in any specific application or arising from any course of dealing or usage of trade. The user is solely responsible for determining the suitability of the product(s) featured herein for user's intended purpose and in user's specific application.

Copyright 2012 C&D TECHNOLOGIES, INC. Printed in U.S.A. 12-1074 0512/CD